

KXF600/KXR600

Exploded parts diagram

Image shown is a KXF600



Date: 2019. 04. 15

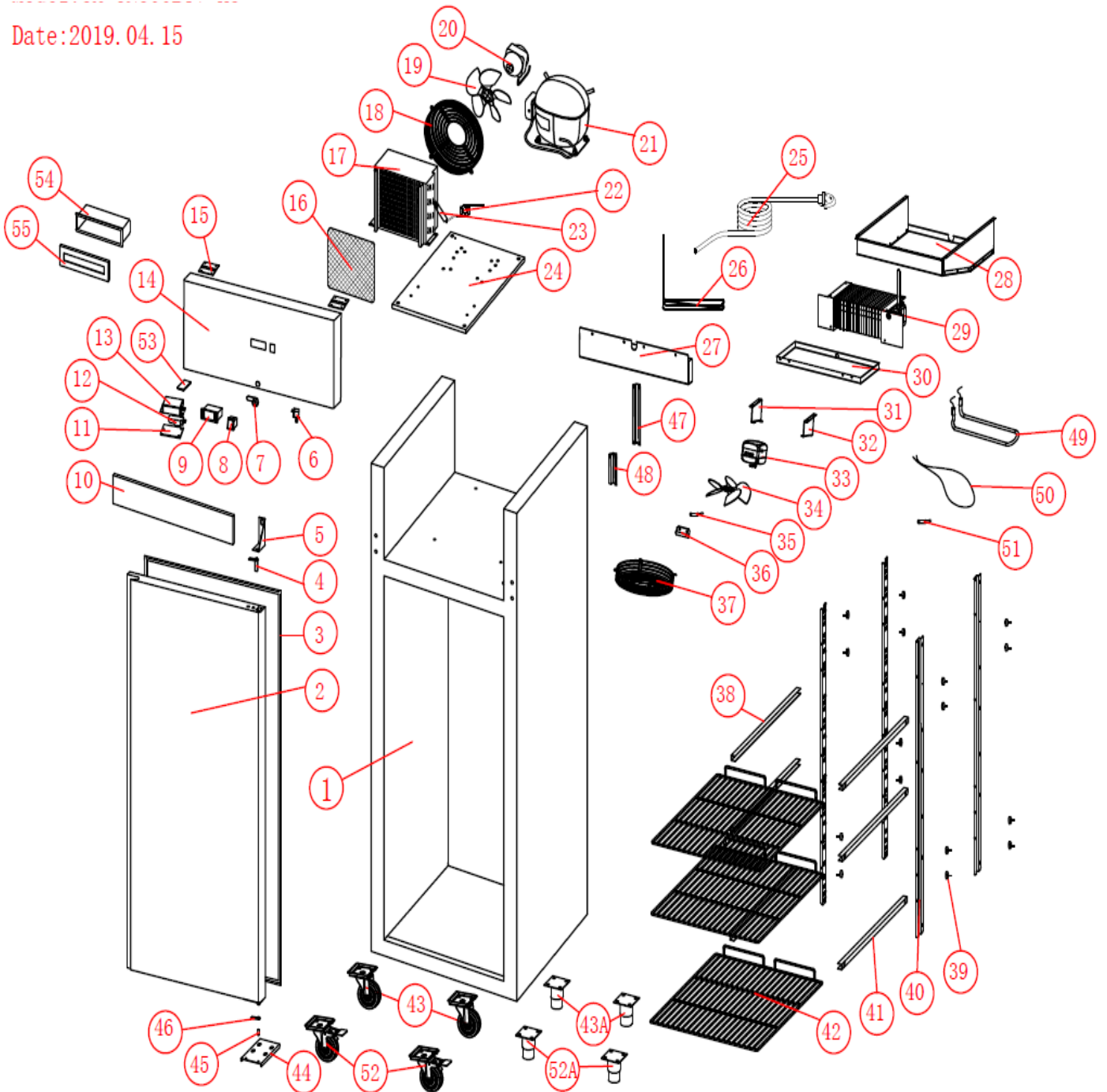



Part Number	Number	Description	Qty
***	1	Cabinet	1
K8-DOOR04	2	Door (KXR & KXF)	1
K8-GASKET03	3	Door Gasket (KXR & KXF)	1
K8-HINGE03	4	Spring Hinge (KXR & KXF)	1
K8-HINGE04	5	RH Upper Hinge (KXR & KXF)	1
K8-SWITCH01	6	Light/Fan switch (KXR & KXF)	1
K8-LOCK03	7	Door Lock (KXR & KXF)	1
K8-SWITCH02	8	Power Switch (KXR & KXF)	1
K8-CONTROLLER02	9	Controller (KXR)	1
K8-CONTROLLER03	9	Controller (KXF)	1
***	10	Inside Air Deflector	1
X1-COVER01	11	Light Cover (KXR & KXF)	1
X1-LED04	12	LED Light (KXR & KXF)	1
***	13	Light Box (KXR & KXF)	1
K8-PANEL600	14	Top Panel (KXR & KXF)	1
***	15	Panel Hinges (KXR & KXF)	2
***	16	Cond. Filter (KXR & KXF)	1
K8-COND02	17	Condenser (KXR)	1
K8-COND03	17	Condenser (KXF)	1
***	18	Cond. Fan Guard (KXR & KXF)	1
***	19	Cond. Fan Blade (KXR & KXF)	1
K8-FAN01	20	Cond. Fan Motor (KXR)	1
K8-FAN03	20	Cond. Fan Motor (KXF)	1
K8-COMP03	21	Compressor	1
K9-COMP04	21	Compressor	
K8-CAPILLARY01	22	Capillary (KXR & KXF)	1
***	23	Drier	1
***	24	Cooling Unit Board (KXR & KXF)	1
***	25	Power Cord (KXR & KXF)	1
***	26	Vaporising Coil	1
K8-TRAY01	27	Vaporising Tray (KXR & KXF)	1
***	28	Evap. Cover	1
K8-EVAP03	29	Evaporator (KXR)	1
K8-EVAP04	29	Evaporator (KXF)	
K8-TRAY02	30	Evap Drip Tray (KXR & KXF)	1
***	31	Left Fan Support	1
***	32	Right Fan Support	1
K8-FAN02	33	Evap Fan motor	1
K8-BLADE01	34	Evap Fan Blade	1
K8-PROBE02	35	Sensor (KXR & KXF)	1
***	36	Clip	1

***	37	Evap Fan Guard	1
K8-GUIDE01	38	Left Shelf Guide, pair (KXR & KXF)	3
***	39	M5 Bolt	16
***	40	Ladder Rack	4
K8-GUIIDE01	41	Right Shelf Guide pair (KXR & KXF)	3
K8-SHELF02	42	Shelf (KXR & KXF)	3
***	43	Unbraked Castor (KXR & KXF)	2
***	43A & 52A	Feet (optional)	4
***	44	Plate	2
K8-HINGE04	45	RH Bottom Hinge (KXR & KXF)	1
K8-HINGEPIN01	46	Hinge Axis (KXR & KXF)	1
K8-BUSH01	47	Hinge Bush	1
***	48	Pipe Protection Cover	1
K8-HEATER	49	Defrost Heater (KXF)	1
K8-HEATER01	50	Drain Heater (KXF)	1
K8-PROBE02	51	Evap Sensor (KXF)	1
***	52	Braked Castor	1
***	53	Blanking Plate	2
***	54	Plastic Waterproof Box	1
***	55	Plastic Water-Proof Box Cover	1

*** Please contact Spares for assistance ***