

# CATER-WASH

## 12kg Washing Machine - Instruction Manual

Model: CK8512

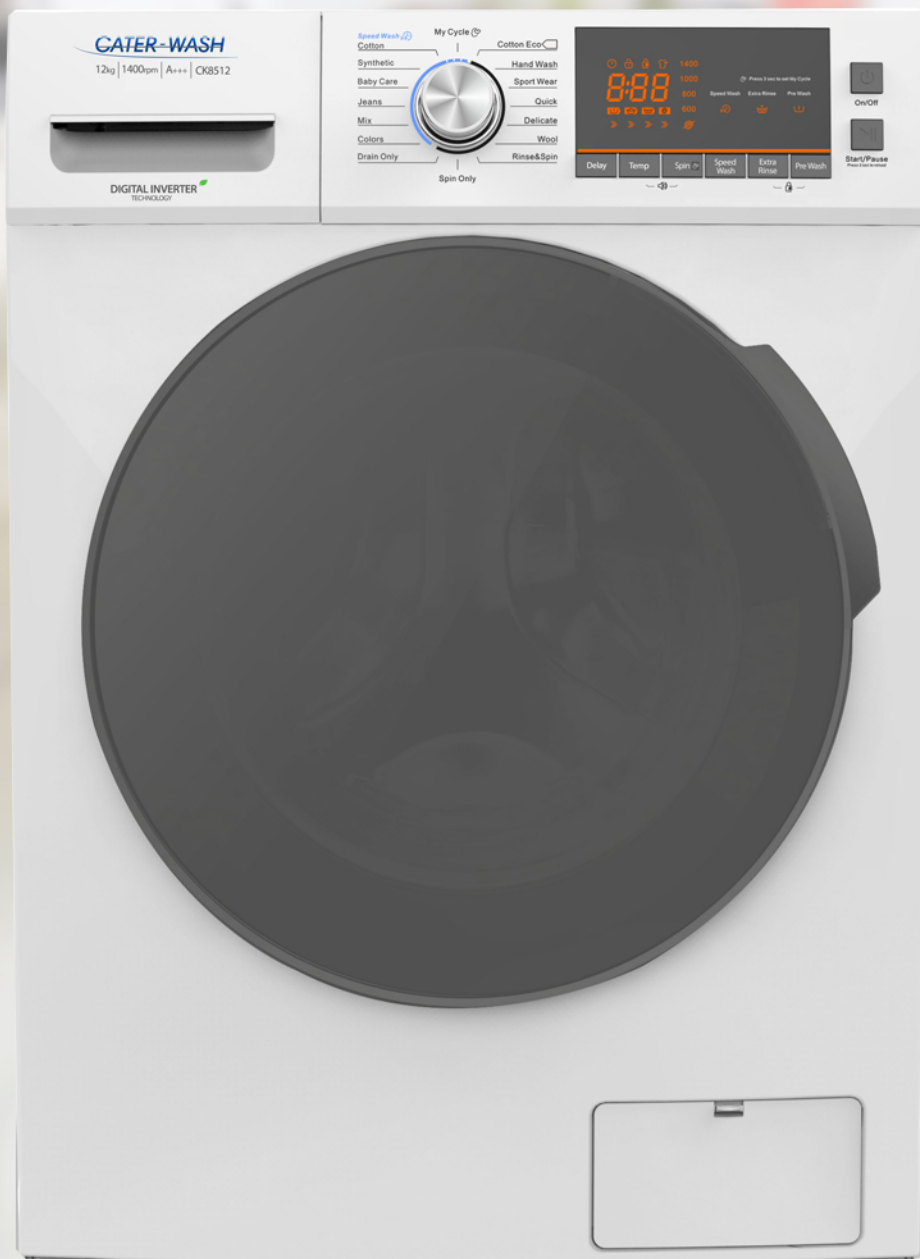

To avoid risk of accidents or damage to the appliance, it is essential to read these instructions before it is installed and used for the first time.

**197**  
kWh/ annum



**76db**

**Caterkwik Ltd**

The Lakeland Catering Centre  
Newlands  
Ulverston  
Cumbria  
LA12 7QQ

01229 480001

info@caterkwik.co.uk

# SAFETY INSTRUCTIONS

---

## ■ Safety Instructions

For your safety, the information in this manual must be followed to minimize the risk of fire or explosion, electric shock, or to prevent property damage, personal injury or loss of life.

Explanation of the symbols:

### Warning!

This combination of symbol and signal word indicates a potentially dangerous situation which may result in death or serious injuries unless it's avoided.

### Caution!

This combination of symbol and signal word indicates a potentially dangerous situation which may result in slight or minor injuries or damage to property and the environment.

### Note!

This combination of symbol and signal word indicates a potentially dangerous situation which may result in slight or minor injuries.

### Warning!

- If the supply cord is damaged, it must be replaced by the manufacturer, its service agent or similarly qualified persons in order to avoid a hazard.

# SAFETY INSTRUCTIONS

---

- The new hoses supplied with the appliance are to be used and that old hoses should not be reused.
- Before any maintenance to the device, unplug the appliance from the mains.
- Always unplug the machine and turn off the water supply after use.
- To ensure your safety, power plug must be inserted into an earthed three-pole socket. Check carefully and make sure that your socket is properly and reliably earthed.
- Make sure that the water and electrical devices are connected by a qualified technician in accordance with the manufacturer's instructions and local safety regulations.

## **Risk to children!**

- EN countries: the appliance can be used by children aged from 8 years and above and persons with reduced physical, sensory or mental capabilities or lack of experience and knowledge if they have been given supervision or instruction concerning use of the appliance in a safe way and understand the hazards involved. Children shall not play with the appliance. Cleaning and user maintenance shall not be made by children without supervision.
- Children of less than 3 years should be supervised to ensure that they do not play with appliance.
- Animals and children may climb into the machine. Check the machine before every operation to ensure the drum is clear.

# SAFETY INSTRUCTIONS

---

- Glass door may be very hot during the operation. Keep kids and pets far away from the machine during the operation.
- Remove all packaging and transport bolts before using the appliance. Otherwise, serious damage may result.
- Plug must be accessible after installation.

## Risk of explosion!

- Do not wash or dry articles that have been cleaned in, washed in, soaked in, or dabbed with combustible or explosive substances (such as wax, oil, paint, gasoline, degreasers, dry-cleaning solvents, kerosene, etc.) This may result in fire or explosion.
- Hand wash thoroughly before washing the above articles in the machine

## ⚠ Caution!

## Installing the product!

- This washing machine is for indoor use only.
- It isn't intended to be built-in.
- The openings must not be obstructed by a carpet.
- Washing machine shall not be installed in bath room or very wet rooms as well as in rooms with explosive or caustic gases.
- The washing machine with single inlet valve only can be connected to the cold water supply.
- The plug must be accessible after installation.

# SAFETY INSTRUCTIONS

---

- Remove all packages and transport bolts before using the appliance. Otherwise, serious damage may result.

## Risk of damaging appliance!

- Your product is only for home use and is only designed for the textiles suitable for machine washing.
- Do not climb up and sit on top cover of the machine.
- Do not lean against machine door.
- Cautions during Handling Machine:
  1. Transport bolts shall be reinstalled to the machine by a specialized person when transporting.
  2. The accumulated water shall be drained out of the machine.
  3. Handle the machine carefully. Never hold each protruded part on the machine while lifting. Machine door can not be used as the handle during the conveyance.
  4. This appliance is heavy. Transport with care.
- Please do not close the door with excessive force. If it is difficult to close the door, please check the clothes are put in or distributed well.
- It is forbidden to wash carpets.

## Operating the appliance!

- Before washing the clothes for the first time, the product shall be operated for one cycle without the clothes inside.
- Flammable, explosive or toxic solvents are forbidden. Gasoline and alcohol etc. Shall not be used as detergents. Please only use detergents suitable for machine washing.

# SAFETY INSTRUCTIONS

---

- Make sure that all pockets are emptied. Sharp and rigid items such as coins, broochs, nails, screws or stones etc. may cause serious damages to this machine.
- Please check whether the water inside the drum has been drained before opening its door. Please do not open the door if there is any water visible.
- Be careful of scolding when the product drains hot washing water.
- Never refill the water by hand during washing.
- After the program is completed, please wait for two minutes to open the door.

## Packaging/disposal



This marking indicates that this product should not be disposed with other household wastes throughout the EU. To prevent possible harm to the environment or human health from uncontrolled waste disposal, recycle it responsibly to promote the sustainable reuse of material resources. To return your used device, please use the collection systems or contact the retailer where the product was purchased for disposal under WEEE regulations.

# INSTALLATION

## ■ Product Description

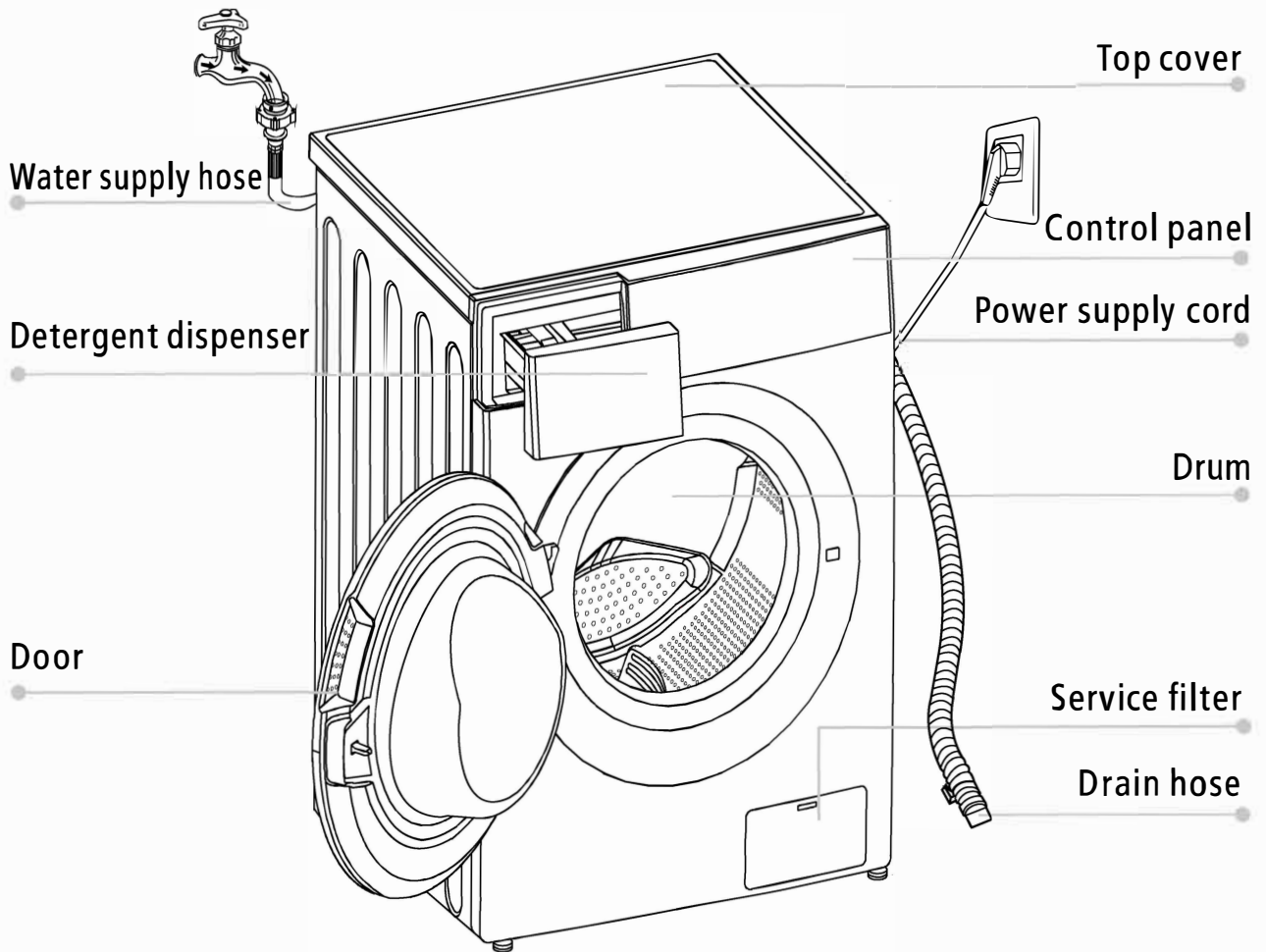

### Note!

- The product diagram is for reference only.

## Accessories

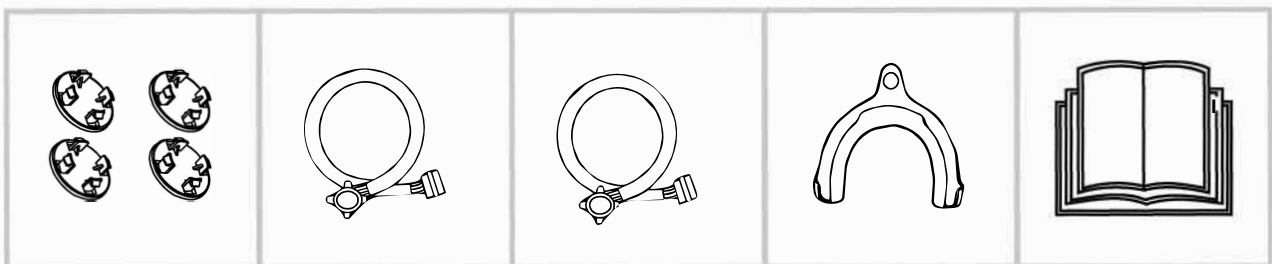

Transport bolt  
hole plug

Supply hose  
cold water

Supply hose hot  
water (optional)

Drain hose support  
(optional)

Owner's manual

# INSTALLATION

## ■ Installation

### Installation area

#### ⚠ Warning!

- Stability is important to prevent the product from wandering!
- Make sure that the product does not stand on the power cord.

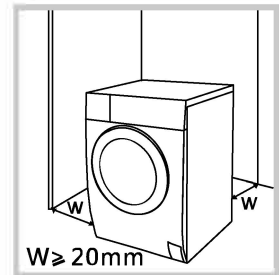

Before installing the machine, the location should meet the following requirements.

1. Rigid, dry, and level surface
2. Avoid direct sunlight
3. Sufficient ventilation
4. Room temperature is above 0°C
5. Keep far away from sources of heat.

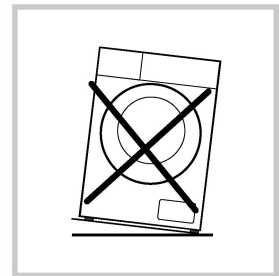

### Unpacking the washing machine

#### ⚠ Warning!

- Packaging material (e.g. Films, Styrofoam) can be dangerous for children.
- There is a risk of suffocation ! Keep all packaging well away from children.

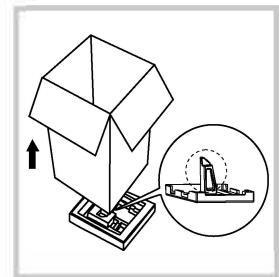

1. Remove the cardboard box and styrofoam packing.
2. Lift the washing machine and remove the base packing. Make sure the triangular foam piece is removed with the bottom one together. If not, lay the unit down with side surface, then remove the foam from under the unit manually.
3. Remove the tape securing the power supply cord and drain hose.
4. Remove the inlet hose from the drum.

### Remove transport bolts

#### ⚠ Warning!

- You must remove the transport bolts from the rear of the machine before using the product.
- You'll need the transport bolts again if you move the product, so make sure you keep them in a safe place.

Please take the following steps to remove the bolts:

1. Loosen 4 bolts with spanner and then remove them.
2. Stop the holes with transport hole plugs.
3. Keep the transport bolts in a safe place for future use.

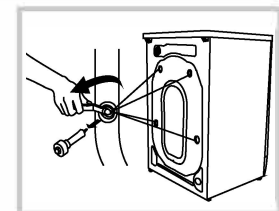



# INSTALLATION

## Levelling the washing machine

### ⚠ Warning!

- The lock nuts on all four feet must be screwed tightly against the housing.

1. Check if the legs are closely attached to the cabinet. If not, please turn them to their original positions by tightening the nuts.
2. Loosen the lock nut turn the feet until it closely contacts with the floor.
3. Adjust the legs and lock them with a spanner, make sure the machine is steady.

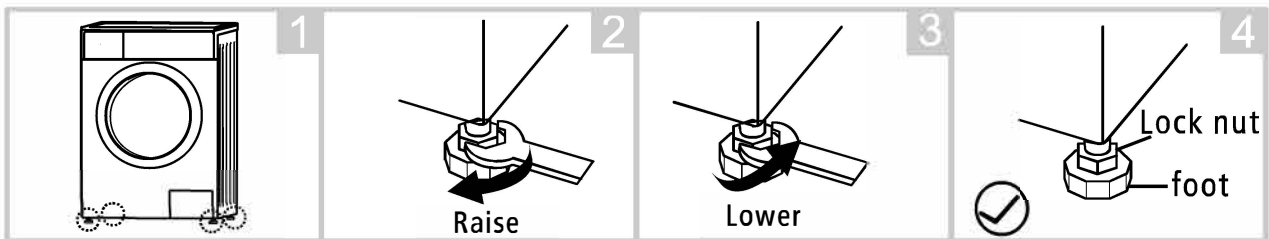

## Connect Water Supply Hose

### ⚠ Warning!

- To prevent leakage or water damage, follow the instructions in this chapter!
- Do not kink, crush, modify or sever water inlet hose.

Connect the inlet pipe as indicated, There are two ways to connect the inlet pipe.

1. Connection between ordinary tap and inlet hose.

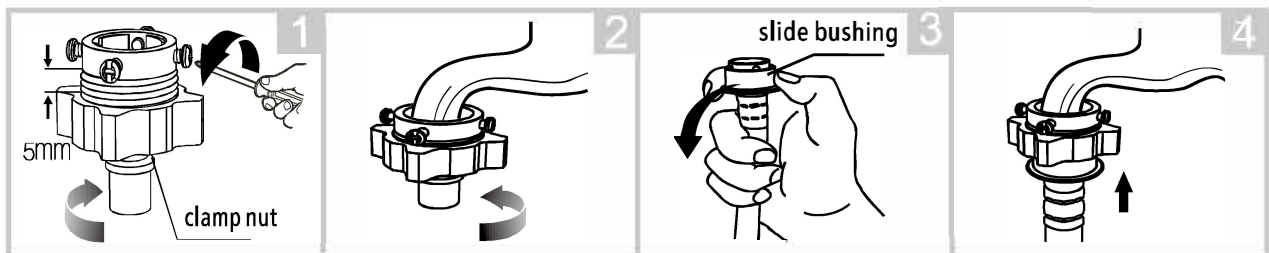

Loosen clamp nut and four bolts

Tighten clamp nut

Press slide bushing, insert inlet hose into connecting base

Connection finished

2. Connection between screw tap and inlet hose.

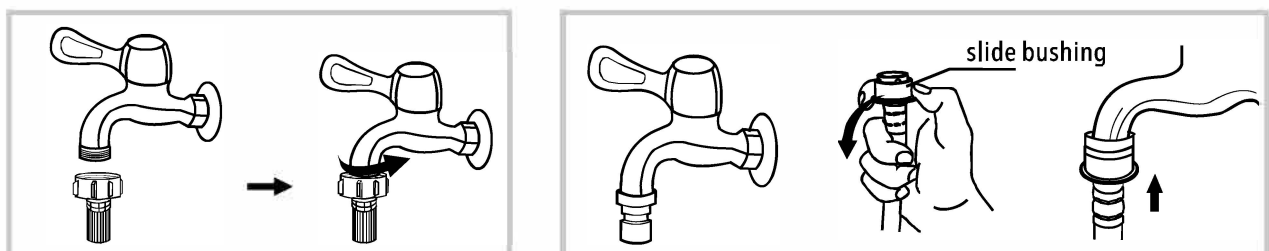

Tap with threads and inlet hose

Special tap for washing machine

# INSTALLATION

Connect the other end of inlet pipe to the inlet valve at the rear of product and fasten the pipe tightly clockwise.

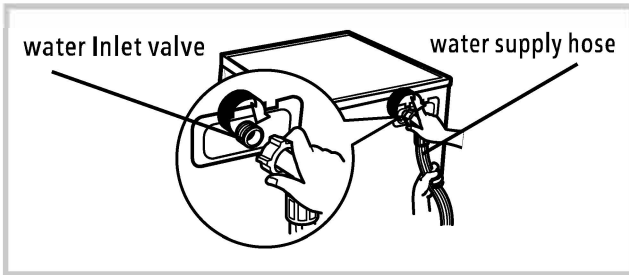

## Drain Hose

### ⚠ Warning!

- Do not kink or stretch the drain hose.
- Position drain hose properly, otherwise damage might occur resulting in water leakage.

There are two ways to place the end of drain hose:

1. Put it into the water trough.

2. Connect it to the branch drain pipe of the trough.

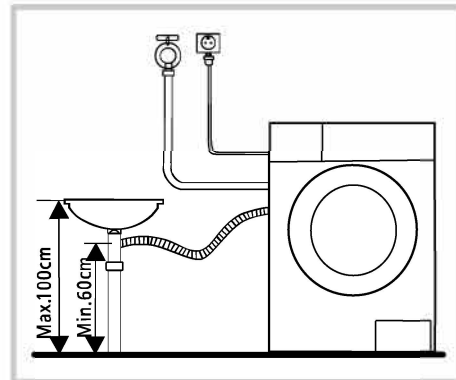
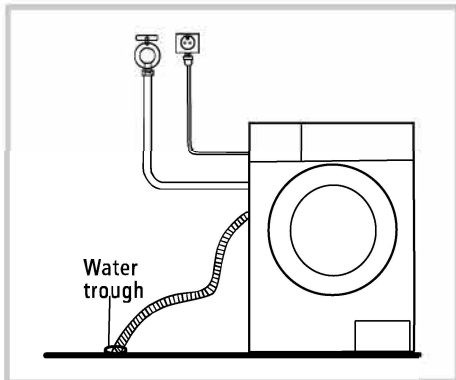

### 📌 Note!

- If the machine has drain hose support, please install it like the following .

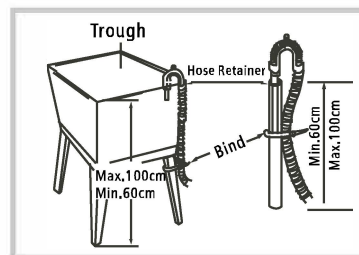
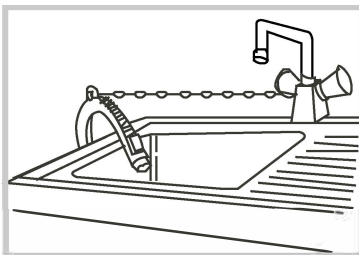

### ⚠ Warning!

- When installing drain hose, fix it properly.
- If drain hose is too long, do not force it into washing machine as it will cause abnormal noises.

# OPERATIONS

## ■ Quick Start

### ⚠ Caution!

- Before washing, please make sure it's installed properly.
- Before operating for the first time, run a cycle with no garments to check the installation.

## ■ Before Washing

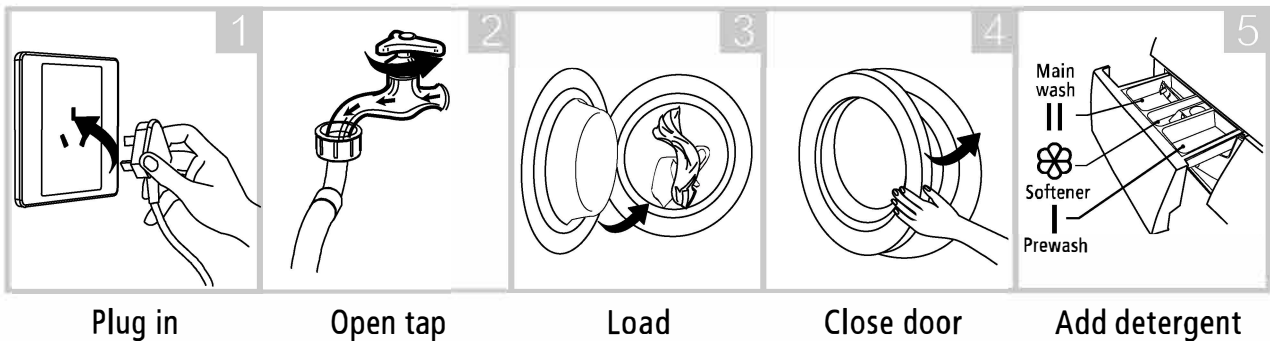

### 📌 Note!

- Detergent only need to be added in "case I" after selecting pre-washing.

## 2. Washing

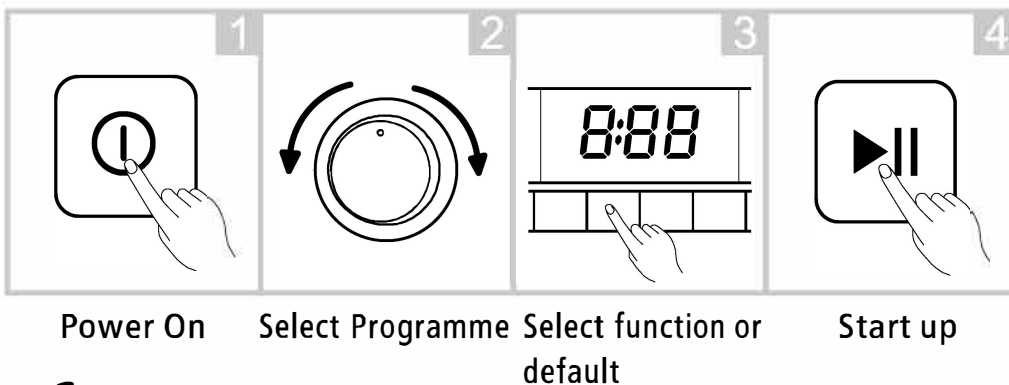

### 📌 Note!

- If default is selected, step 3 can be skipped.

## 3. After Washing

Buzzer beep or "End" on display.

# OPERATIONS

## ■ Before Each Wash

- The working condition of the washer should be (0-40) °C. If used under 0 °C, the inlet valve and draining system may be adversely affected & damaged. If the machine is placed under condition of 0 °C or less, then it should be transferred to normal ambient temperature to ensure the water supply hose and drain hose are not frozen before use.
- Please check the labels and the wash instructions of all items before wash. Use non-foaming or reduced-foaming detergent suitable for machine washing.

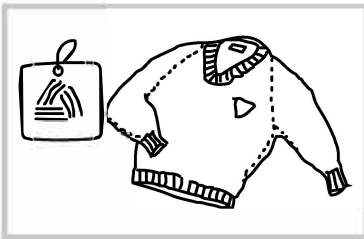

Check the label

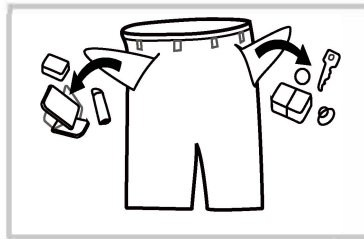

Take out the items out of the pockets

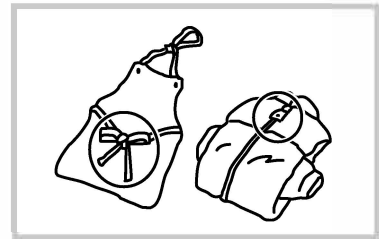

Knot the long strips, fasten the zips or buttons

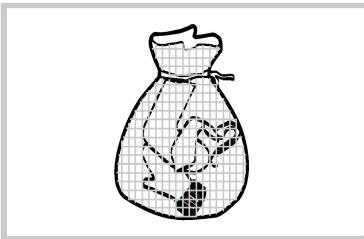

Put small clothes into the pillow slip

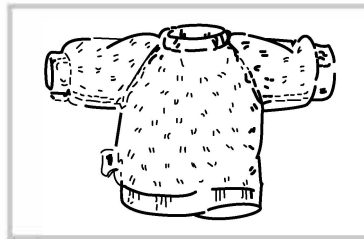

Turn easy-pilling and long-pile fabric inside out

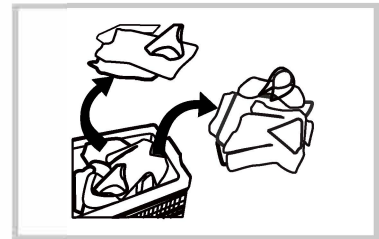

Separate clothes with different textures

### ⚠ Warning!

- When washing a single clothes, it may easily cause unbalance. Therefore it is suggested to add one or two more clothes to be washed together so that draining can be done smoothly.
- Don't wash items containing kerosene, gasoline, alcohol and other flammable materials.

# OPERATIONS

## ■ Detergent Dispenser

- I Pre wash detergent
- II Main wash detergent
- ☼ Softener

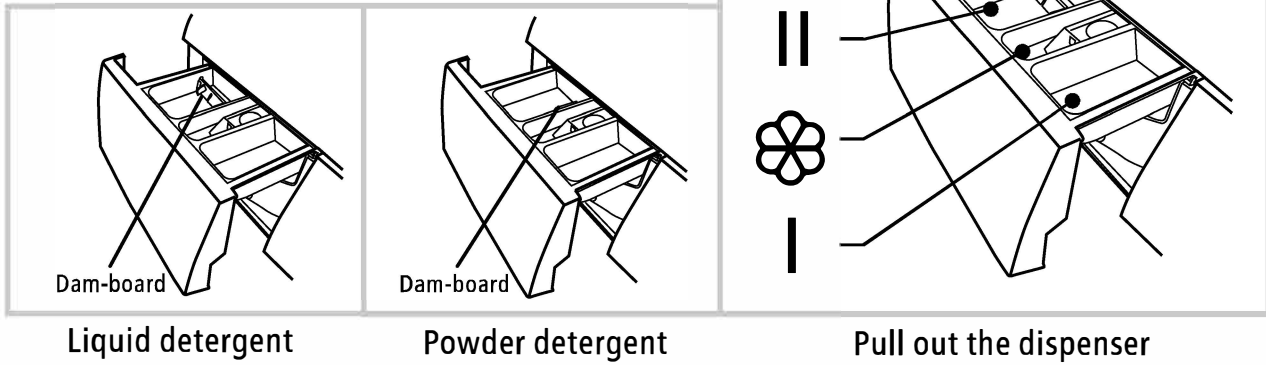

Liquid detergent

Powder detergent

Pull out the dispenser

### ⚠ Caution!

- Detergent only need to be added in "compartment I " after selecting pre-washing.

Programme	I	II	☼	Programme	I	II	☼
Cotton	○	●	○	Rinse&Spin			○
Synthetic	○	●	○	Wool		●	○
Baby Care	○	●	○	Delicate		●	○
Jeans	○	●	○	Quick		●	○
Mix	○	●	○	Sport Wear	○	●	○
Colours		●	○	Hand Wash	○	●	○
Drain Only				Cotton ECO		●	○
Anti-Allergic Wash	○	●	○	Normal	○	●	○
Tower	○	●	○	Quiet wash		●	○
Stain Wash		●	○	Cold Wash		●	○

Spin Only

● Means must      ○ Means optional

### 📌 Note!

- As for the detergent or additive, before they are poured into the detergent box, it is suggested to use some water for dilution to prevent the inlet of detergent box from being blocked and overflowing while filling water.
- Please choose suitable type of detergent for the selected washing temperature to get the best washing performance with less water and energy consumption.

# OPERATIONS

## Control Panel

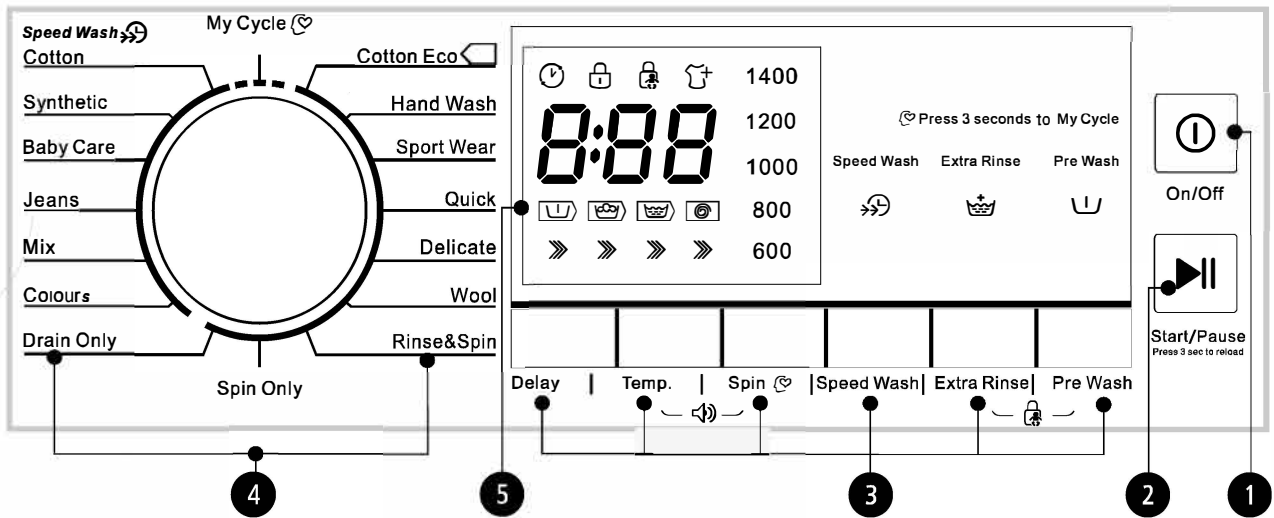

### Note!

- The chart is for reference only.

#### 1 On/Off

Product is switched on or off.

#### 2 Start/Pause

Press the button to start or pause the washing cycle.

#### 3 Option

This allows you to select an additional function and will light when selected.

#### 4 Programmes

Available according to the laundry type.

#### 5 Display

The display shows the settings, estimated time remaining, options, and status messages for your washer. The display will remain on through the cycle.

<b>A</b> Delay	<b>F</b> Pre Wash
<b>B</b> Door Lock	<b>G</b> Extra Rinse
<b>C</b> Child Lock	<b>H</b> Speed Wash
<b>D</b> Reload	<b>I</b> Spin Speed
<b>E</b> My Cycle	
<b>J</b> Rate Of Progress(Pre wash- Wash -Rinse-Spin)	
<b>K</b> Wash Time	Delay Time
1:25	2h
Error	End
E20	End

# OPERATIONS

---

## ■ Option



### Pre Wash

The Prewash function provides a pre soak before the main cycle begins.

---



### Extra Rinse

The laundry will undergo extra rinse if selected.

---



### Speed Wash

The function can decrease the washing time.

---



### Delay

Set the Delay function:

1. Select a programme
2. Press the Delay button to choose the time (the delaying time is 0-24 H.)
3. Press [Start/Pause] to commence the delay operation



Cancel the Delay function:

Press the [Delay] button until the display reads 0H. It should be pressed before starting the programme. If the programme has already started, press the [On/Off] button to reset the programme.

---

## ⚠ Caution!

- If there is any break in the power supply while the machine is operating, the machine will store the selected program & continue when power is restored.

# OPERATIONS

Programme	Option				Programme	Option			
	Delay	Speed wash	Extra rinse	Pre wash		Delay	Speed wash	Extra rinse	Pre wash
Cotton	<input type="radio"/>	<input type="radio"/>	<input type="radio"/>	<input type="radio"/>	Rinse&Spin	<input type="radio"/>		<input type="radio"/>	
Synthetic	<input type="radio"/>	<input type="radio"/>	<input type="radio"/>	<input type="radio"/>	Wool	<input type="radio"/>		<input type="radio"/>	
Baby Care	<input type="radio"/>	<input type="radio"/>	<input type="radio"/>	<input type="radio"/>	Delicate	<input type="radio"/>		<input type="radio"/>	
Jeans	<input type="radio"/>	<input type="radio"/>	<input type="radio"/>	<input type="radio"/>	Quick	<input type="radio"/>			
Mix	<input type="radio"/>	<input type="radio"/>	<input type="radio"/>	<input type="radio"/>	Sport Wear	<input type="radio"/>		<input type="radio"/>	<input type="radio"/>
Colours	<input type="radio"/>	<input type="radio"/>	<input type="radio"/>		Hand Wash	<input type="radio"/>		<input type="radio"/>	<input type="radio"/>
Drain Only	<input type="radio"/>				Cotton ECO	<input type="radio"/>			
Spin Only	<input type="radio"/>				Normal	<input type="radio"/>	<input type="radio"/>	<input type="radio"/>	<input type="radio"/>
Tower	<input type="radio"/>	<input type="radio"/>	<input type="radio"/>	<input type="radio"/>	Quiet wash	<input type="radio"/>			
Stain Wash	<input type="radio"/>		<input type="radio"/>		Cold Wash	<input type="radio"/>		<input type="radio"/>	
Anti-Allergic Wash	<input type="radio"/>		<input type="radio"/>	<input checked="" type="radio"/>	Eco Wash	<input type="radio"/>	<input type="radio"/>	<input type="radio"/>	

● Means must      ○ Means optional



# OPERATIONS

## ■ Other functions



### Reload

This operation can be executed during the washing progress. When the drum is still rolling and there is large amount of water with high temperature in the drum. The state is unsafe and the door cannot be opened forcefully. To press [Start/Pause] for 3 sec. To reload, and start the clothes adding in the midway function. Please follow the steps as below:

- 1.Wait until the drum stops rotation.
- 2.The door lock is unlocked.
- 3.Close the door when the clothes are reloaded and press the [Start/Pause] button.



Press [Start/Pause] 3sec.



Reload the clothes



Start

### ⚠ Caution!

- Don't use the Reload function when the water level over the edge of the inner tub or the temperature is higher.



### Child Lock

To avoid mis operation by children.



On/Off



Start



Press [Extra Rinse] and [Pre Wash]  
3 sec. till buzzer beep.

### ⚠ Caution!

- Press the two button 3sec. also to be released the function.
- The "Child Lock" will lock all buttons except [ On/Off ].
- Cut off the power supply , the kid's protection is to be released.
- The child lock will remain effective when the power is resumed for some models.

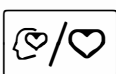

### My Cycle

Memory the frequently used programmes

Press [Spin] 3sec. to memory the running programme.The default is cotton.



### Temp./Temperature

Press the button to regulate the temperature(Cold,20°C,30°C, 40°C,60°C,90°C)

# OPERATIONS

Spin

## Spin

Press the button to change the spin speed.

1000: 0-400-600-800-1000

1200: 0-400-600-800-1000-1200

1400: 0-600-800-1000-1200-1400

1600: 0-400-800-1200-1400-1600

Programme	Default Speed(rpm)			
	1000	1200	1400	1600
Cotton		800		
Synthetic		800		
Baby Care		800		
Jeans		800		
Mix		800		
Colours Drain	800	1000	1000	1000
Only Spin		—		
Only Tower	800	800	1000	1000
Stain Wash			800	
Drum Clean			1200	

Programme	Default Speed(rpm)			
	1000	1200	1400	1600
Rinse&Spin	800	1000 800(Slim)	1000	1200
Wool			600	
Delicate			600	
Quick			800	
Sport Wear	1000	1000 1200(Slim)	1000	1200
Hand Wash			1000	
Cotton ECO	1000	1200	1400	1600
Normal			800	
Silence wash			800	
Cold Wash			800	
Anti-Allergic Wash			800	

# OPERATIONS

Programme	Default Speed(rpm)		Programme	Default Speed(rpm)	
	1200	1400		1200	1400
Cotton	1200	1400	Rinse&Spin	800	800
Synthetic	1200	1400	Wool	600	600
Baby Care	800	800	Delicate	600	600
Jeans	800	800	Quick	800	800
Mix	800	800	Sport Wear	1200	1400
Drain Only	—	—	Hand Wash	600	600
Spin Only	800	800	Cotton ECO	1200	1400
			Eco Wash	1000	1000

## ⚠ Caution!

- When the lights of spin speed (400,600,800,1000,1200,1400) are off means the spin speed is 0.

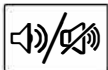

Mute the buzzer



On/Off



Start



Temp.



Spin

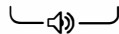

Press the [Temp.]&[Spin] button for 3sec. the buzzer is mute.

To act the buzzer function, press the two buttons again for 3 seconds. The setting will be kept until the next reset.

## ⚠ Caution!

- After Muting the buzzer function, the sounds will not be activated any more.

# OPERATIONS

---

## ■ Programmes

Programmes are available according to the laundry type.

Programmes	
Cotton	Hard-wearing textiles, heat-resistant textiles made of cotton or linen.
Synthetic	Wash synthetic articles, for example: shirts, coats, blending. While washing knitting textiles, detergent quantity shall be reduced.
Baby Care	Washing the baby's clothes, it can make the baby's wear cleaner and make the rinse performance better to protect the baby skin.
Jeans	Specially for jeans.
Mix	Mixed load consisting of textiles made of cotton and synthetics.
Colours	Washing brightly coloured clothes & protects the colours.
Cotton Eco	To increase the washing effects, washing time is increased.
Hand Wash	For few lightly soiled clothes, the default temperature of washing is cold.
Sport Wear	Activewear.
Quick	Extra short programme approx, suitable for lightly soiled washing as a small amounts of laundry.
Delicate	For delicate, washable textiles, e.g. made of silk, satin, synthetic fibres or blended fabrics.
Wool	Hand or machine-washable wool or richwool textiles. Especially gentle wash programme to prevent shrinkage, longer programme pauses.
Spin Only	Extra spin with selectable spin speed.
Rinse&Spin	Extra rinse with spin.
Drain Only	Drain the water.
Eco Wash	Cold-water washing preserves original Colours, saves energy and still delivers great cleaning performance.

# OPERATIONS

## ■ Washing Programmes Table

Programme	Load(kg)			Temp.(°C)	Default Time				
	6.0	7.0	8.0		Default	6.0	6.0 / 6.0(slim)	6.0	7.0/8.0
					1000	1200	1400	1200	1400
Cotton	6.0	7.0	8.0	40	2:40	2:40	2:40	2:40	2:40
Synthetic	3.0	3.5	4.0	40	1:40	1:40	1:40	1:40	1:40
Baby Care	6.0	7.0	8.0	30	1:20	1:20	1:20	1:20	1:20
Jeans	6.0	7.0	8.0	60	1:45	1:45	1:45	1:45	1:45
Mix	6.0	7.0	8.0	40	1:13	1:13	1:13	1:13	1:13
Colours	3.0	3.5	4.0	Cold	1:10	1:10	1:10	1:10	1:10
Drain Only	—	—	—	—	0:01	0:01	0:01	0:01	0:01
Spin Only	6.0	7.0	8.0	—	0:12	0:12	0:12	0:12	0:12
Rinse&Spin	6.0	7.0	8.0	—	0:20	0:20	0:20	0:20	0:20
Wool	2.0	2.0	2.0	40	1:07	1:07	1:07	1:07	1:07
Delicate	2.5	2.5	2.5	30	0:50	0:50	0:50	0:50	0:50
Quick	2.0	2.0	2.0	Cold	0:15	0:15	0:15	0:15	0:15
Sport Wear	3.0	3.5	4.0	40	0:45	0:45	0:45	0:45	0:45
Hand Wash	2.0	2.0	2.0	Cold	1:00	1:00	1:00	1:00	1:00
Cotton ECO	6.0	7.0	8.0	60	2:53	2:56 / 4:32	2:51	2:58	2:53

- The EU energy efficiency class A+++  
Energy test program: Cotton ECO 60/40°C.  
Speed: the highest speed; Other as the default.  
Half load for 6.0/7.0/8.0Kg machine:3.0/3.5/4.0Kg.
- "Cotton ECO 60/40°C " is the standard washing programs to which the information in the label and they are suitable to clean normally soiled cotton laundry and that they are the most efficient programmes in terms of combined energy and water consumptions for washing that type of cotton laundry, the actual water temperature may differ from the declared cycle temperature.

### Note!

- The parameters in this table are only for user's reference. The actual parameters maybe different with the parameters in above mentioned table.

# OPERATIONS

## ■ Washing Programmes Table(Inverter)

Model:EU(A3)-FC60-S12D/C1401E/EU(A3)-FC70-S14D/C1401E/EU(A3)-FC80-S12D/C1401E /MFC90-ES1401/C1457ED

Programme	Load(kg)				Temp.(°C)	Default Time			
	6.0	7.0	8.0	9.0		6.0	7.0	8.0	9.0
					Default	1200	1400	1200	1400
Cotton	6.0	7.0	8.0	9.0	40	2:40		2:40	
Synthetic	3.0	3.5	4.0	4.5	40	1:40		1:40	
Baby Care	6.0	7.0	8.0	9.0	30	1:20		1:20	
Jeans	6.0	7.0	8.0	9.0	60	1:45		1:45	
Mix	6.0	7.0	8.0	9.0	40	1:13		1:13	
Colours	3.0	3.5	4.0	4.5	Cold	1:10		1:10	
Drain Only	—	—	—	—	—	0:01		0:01	
Spin Only	6.0	7.0	8.0	9.0	—	0:12		0:12	
Rinse&Spin	6.0	7.0	8.0	9.0	—	0:20		0:20	
Wool	2.0	2.0	2.0	2.0	40	1:07		1:07	
Delicate	2.5	2.5	2.5	2.5	30	0:50		0:50	
Quick	2.0	2.0	2.0	2.0	Cold	0:15		0:15	
Sport Wear	3.0	3.5	4.0	4.5	40	0:45		0:45	
Hand Wash	2.0	2.0	2.0	2.0	Cold	1:00		1:00	
Cotton ECO	6.0	7.0	8.0	9.0	60	3:48		3:42	

- The EU energy efficiency class A+++  
Energy test program: Cotton ECO 60/40°C; Speed: the highest speed; Other as the default; Half load for 6.0/7.0/8.0/9.0Kg machine:3.0/3.5/4.0/4.5Kg.
- “Cotton ECO 60/40°C ” is the standard washing programs to which the information in the label and the fiche relates, and they are suitable to clean normally soiled cotton laundry and that they are the most efficient programmes in terms of combined energy and water consumptions for washing that type of cotton laundry, that the actual water temperature may differ from the declared cycle temperature.

### Note!

- The parameters in this table are only for user's reference. The actual parameters maybe different with the parameters in above mentioned table.

# OPERATIONS

## ■ Washing Programmes Table(Inverter)

Model:MFC80-S1201D/C14E-LB(A3)/MFC100-U1401B/C14E-LB(A33)/  
MFC120-U1401B/C14E-LB(A33)

Programme	Load(kg)			Temp.(°C)	Default Time		
	8.0	10.0	12.0		8.0	10.0	12.0
				Default	12:00	14:00	14:00
Cotton ECO	8.0	10.0	12.0	60	3:42	4:14	3:58
Jeans	8.0	10.0	12.0	60	1:45	1:45	1:45
Sport Wear	4.0	5.0	6.0	40	1:31	1:31	1:31
Quick	2.0	2.0	2.0	Cold	0:15	0:15	0:15
Delicate	2.5	2.5	2.5	30	1:00	1:00	1:00
Wool	2.0	2.0	2.0	40	1:07	1:07	1:07
Rinse&Spin	8.0	10.0	12.0	—	0:20	0:20	0:20
Spin Only	8.0	10.0	12.0	—	0:12	0:12	0:12
Drain Only	—	—	—	—	0:01	0:01	0:01
Eco Wash	2.0	2.0	2.0	Cold	1:08	1:08	1:08
Mix	8.0	10.0	12.0	30	0:48	0:48	0:48
Hand Wash	2.0	2.0	2.0	Cold	1:03	1:03	1:03
Baby Care	8.0	10.0	12.0	30	1:34	1:34	1:34
Synthetic	4.0	5.0	6.0	40	2:20	2:20	2:20
Cotton	8.0	10.0	12.0	40	2:40	2:40	2:40

- The EU energy efficiency class A+++  
Energy test program: Cotton ECO 60/40°C; Speed: the highest speed; Other as the default; Half load for 8.0/10.0/12.0Kg machine:4.0/5.0/6.0Kg.
- "Cotton ECO 60/40°C " is the standard washing programs to which the information in the label and the fiche relates, and they are suitable to clean normally soiled cotton laundry and that they are the most efficient programmes in terms of combined energy and water consumptions for washing that type of cotton laundry, that the actual water temperature may differ from the declared cycle temperature.

### Note!

- The parameters in this table are only for user's reference. The actual parameters maybe different with the parameters in above mentioned table.

# OPERATIONS

## ■ Washing Programmes Table(Slim)

Model:MFC80-U1401/C1457E /MFC80-U1401/C1457EB/MFC100-U1601B/C14E-EU(A33)  
/MFC120-U1401B/C14E-LA/MFC120-U1601B/C14E-LA

Programme	Load(kg)			Temp.(°C)	Default Time				
	8.0	10.0	12.0		8.0	8.0(inverter)	10.0	12.0	12.0
				Default	1400	1400	1600	1400	1600
Cotton	8.0	10.0	12.0	40	2:40	2:40	2:40	2:40	2:40
Synthetic	4.0	5.0	6.0	40	1:40	1:40	1:40	1:40	1:40
Baby Care	8.0	10.0	12.0	30	1:20	1:20	1:20	1:20	1:20
Jeans	8.0	10.0	12.0	60	1:45	1:45	1:45	1:45	1:45
Mix	8.0	10.0	12.0	40	1:13	1:13	1:13	1:13	1:13
Colours	4.0	5.0	6.0	Cold	1:10	1:10	1:10	1:10	1:10
Drain Only	—	—	—	—	0:01	0:01	0:01	0:01	0:01
Spin Only	8.0	10.0	12.0	—	0:12	0:12	0:12	0:12	0:12
Rinse&Spin	8.0	10.0	6.0	—	0:20	0:20	0:20	0:20	0:20
Wool	2.0	2.0	2.0	40	1:07	1:07	1:17	1:17	1:17
Delicate	2.5	2.5	2.5	30	0:50	0:50	0:50	0:50	0:50
Quick	2.0	2.0	2.0	Cold	0:15	0:15	0:15	0:15	0:15
Sport Wear	4.0	5.0	6.0	40	0:45	0:45	0:45	0:45	0:45
Hand Wash	2.0	2.0	2.0	Cold	1:00	1:00	1:00	1:00	1:00
Cotton ECO	8.0	10.0	12.0	60	2:59	3:57	3:59	4:03	4:03

- The EU energy efficiency class is A+++  
Energy test program: Cotton ECO 60/40°C.  
Speed: the highest speed; Other as the default.  
Half load for 8.0/10.0/12.0Kg machine:4.0/5.0/6.0Kg.
- "Cotton ECO 60/40°C " is the standard washing programs to which the information in the label and the fiche relates, and they are suitable to clean normally soiled cotton laundry and that they are the most efficient programmes in terms of combined energy and water consumptions for washing that type of cotton laundry, that the actual water temperature may differ from the declared cycle temperature.

### Note!

- The parameters in this table are only for user's reference. The actual parameters maybe different with the parameters in above mentioned table.



# OPERATIONS

## ■ Washing Programmes Table(Slim)

Model:MFC120-U1401B/C14E-BR05/MFC120-U1401B/C14E-BR20

Programme	Load(kg)	Temp.(°C)	Default Time	
			12.0(inverter)	
	12.0	Default	1400	
Cotton	12.0	60	2:45	
Cold Wash	12.0	Cold	0:58	
Baby Care	12.0	30	1:20	
Jeans	12.0	40	1:48	
Anti-allergic Wash	12.0	60	2:44	
Colours	6.0	Cold	1:10	
Drain Only	—	—	0:01	
Spin Only	12.0	—	0:12	
Rinse&Spin	12.0	Cold	0:20	
Normal	12.0	Cold	1:30	
Delicate	3.0	30	0:50	
Quick 15'	2.0	Cold	0:15	
Stain Wash	12.0	60	3:30	
Silence wash	12.0	60	2:10	
Drum clean	—	90	1:18	
Tower	12.0	60	1:45	

- The BR energy efficiency class is AAA  
Energy test program: Cotton Cold/40°C.  
Speed: the highest speed; Other as the default.  
Half load for 12.0Kg machine:6.0Kg.
- "Cotton Cold/40°C" is the standard washing programs to which the information in the label and the fiche relates, and they are suitable to clean normally soiled cotton laundry and that they are the most efficient programmes in terms of combined energy and water consumptions for washing that type of cotton laundry, that the actual water temperature may differ from the declared cycle temperature.

### Note!

- The parameters in this table are only for user's reference. The actual parameters maybe different with the parameters in above mentioned table.

# MAINTENANCES

## ■ Cleaning And Care

### ⚠ Warning!

- Before your maintenance starts, please unplug the machine and isolate the machine from the water supply.

## Cleaning The Cabinet

Proper maintenance on the washing machine can extend its working life. The surface can be cleaned with diluted non-abrasive neutral detergents when necessary. If there is any water overflow, use the wet cloth to wipe it off immediately. No sharp items are allowed.



### 📌 Note!

- Formic acid and its diluted solvents or equivalent are forbidden, such as alcohol, solvents or chemical products, etc.

## Cleaning The Drum

Any items in the drum must be removed before you clean the drum with chlorine-free detergents. Never use steel wool.

### 📌 Note!

- Don't put laundry in the washing machine during drum cleaning.

## Cleaning The Door Seal And Glass

Wipe the glass and seal after each wash to remove lint and stains. If lint builds up it can cause leaks.

Remove any coins, buttons and other objects from the seal after each wash.

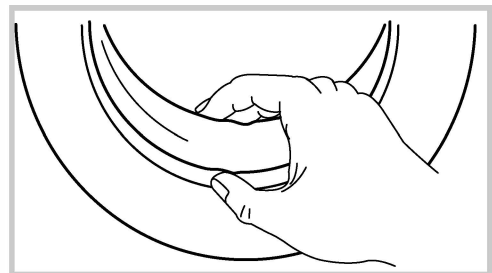

# MAINTENANCES

## Cleaning The Inlet Filter

### Note!

- Check the inlet filter is clear.

Washing the filter in the connection hose

1. Close the tap.
2. Remove the water supply hose from the tap.
3. Clean the filter.
4. Reconnect the water supply hose.

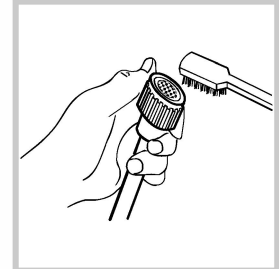
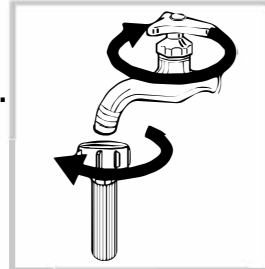

Washing the filter in washing machine:

1. Screw off the inlet pipe from the backside of the machine.
2. Pull out the filter with long nose pliers and reinstall it back after being washed.
3. Use the brush to clean the filter.
4. Reconnect the inlet pipe.

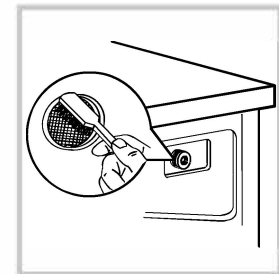
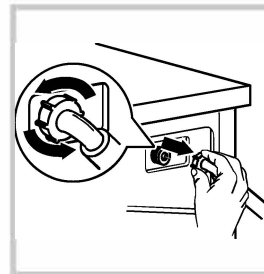

### Note!

- If the brush is not clean, you can pull out the filter and wash separately;
- Reconnect, turn on the tap.

## Clean The Detergent Dispenser

1. Press down the arrow location on softener cover inside the dispenser drawer.
2. Lift the clip up and take out softener cover and wash all grooves with water.
3. Replace the softener cover and push the drawer into position.

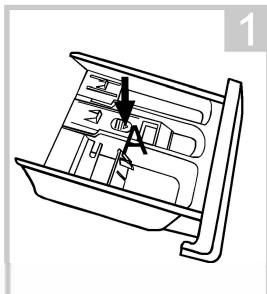

1 Pull out the dispenser drawer with press the A

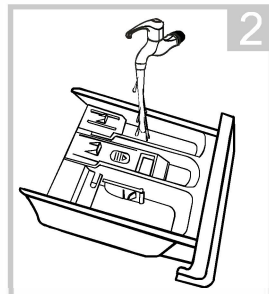

2 Clean the dispenser drawer under water

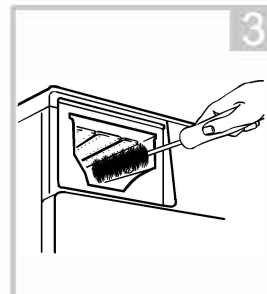

3 Clean inside the recess with brush

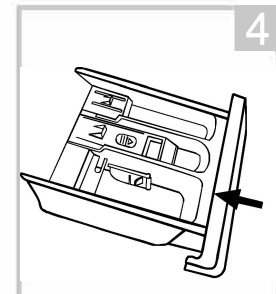

4 Insert the dispenser drawer

### Note!

- Do not use alcohol or solvents to clean the machine.

# MAINTENANCES

## Cleaning The Drain Pump Filter

### ⚠ Warning!

- Be careful of the hot water!
- Allow detergent solution to cool down.
- Unplug the machine to avoid electrical shock before washing.
- Drain pump filter can filter the yarns and small foreign objects.
- Clean the filter periodically to ensure the normal operation of washing machine.

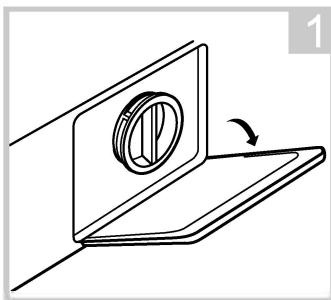

Open the lower cover cap

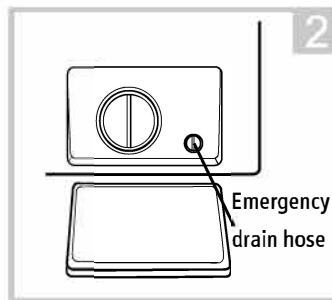

Rotate 90° and pull out the emergency drain hose, and take off the hose cap

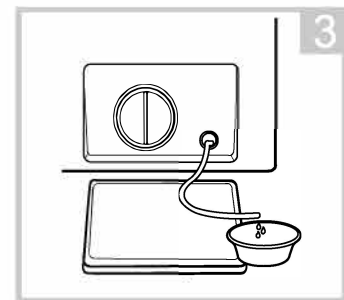

After water runs out, reset the drain hose

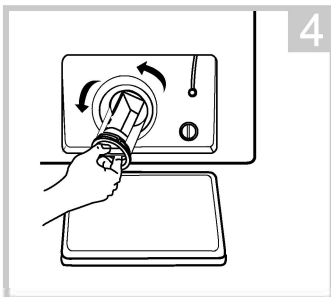

Open the filter by turning to the counter clockwise

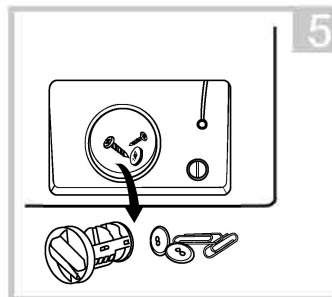

Remove extraneous matter

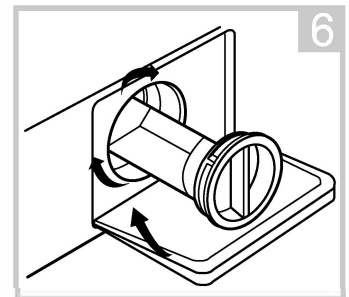

Close the lower cover cap

### ⚠ Caution!

- Make sure that valve cap and emergency drain hose are reinstalled properly, cap plates should be inserted aligning to hole plates otherwise water may leak.
- When the appliance is in use and depending on the programme selected there can be hot water in the pump. Never remove the pump cover during a wash cycle, always wait until the appliance has finished the cycle, and is empty. When replacing the cover, ensure it is securely re-tightened.

# MAINTENANCES

## ■ Trouble Shooting

If the appliance does not work or it stops during operation. First try to find a solution to the problem, If not, contact the service centre.

Description	Reason	Solution
Washing machine cannot start up	Door is not closed properly	Restart after the door is closed Check if clothes are stuck
Door can't be opened	Washer's safety protection design is working	Disconnect the power, restart the product
Water leakage	The connection between inlet pipe or outlet hose is not tight	Check and fasten water pipes Clean up outlet hose
Detergent residues in the box	Detergent is dampened or agglomerated	Clean and wipe the detergent box
Indicator or display does not light	Disconnect the power PC board or harness has connection problem	Check if the power is shut down and the power plug is connected correctly
Abnormal noise		Check if the transport bolts have been removed Check it's installed on a solid and level floor

Description	Reason	Solution
<b>E30</b>	Door is not closed properly	Restart after the door is closed Check if the clothes is stuck
<b>E10</b>	Water injecting problem while washing	Check if the water pressure is too low Straighten the water pipe Check if the inlet valve filter is blocked
<b>E21</b>	Error water draining	Check if the drain hose is blocked
<b>E12</b>	Water overflow	Restart the washer
<b>EXX</b>	Others	Please try again first, call our service line if there are still troubles

### Note!

- After the check, activate the appliance. If the problem occurs or the display shows other alarm codes again, contact the service team on 01229 480001.

# MAINTENANCES

## ■ Technical Specifications

Power Supply 220-240V~,50Hz

MAX.Current 10A

Standard Water Pressure 0.05MPa~1MPa

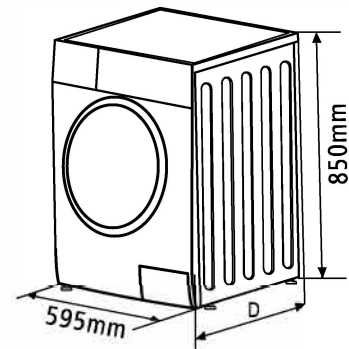

Model	Washing Capacity		Net Weight	Rated Power
CK8512	12.0kg	595*587*85	73kg	2000W

# MAINTENANCES

## ■ Product Features

Model		CK8512
Capacity		12kg
Spin Speed		1400 rpm
Energy efficiency class	①	A+++
Annual energy consumption	②	153 kWh /annual
Power consumption of off - mode		0.5W
Power consumption of Left on -mode		1.0W
Annual water consumption	③	14000L /annual
Spin- drying efficiency class	④	B
Standard washing cycle	⑤	Cotton ECO
Energy consumption of the standard 60°C at full load		0.79/0.79/0.79/0.76 kwh /cycle
Energy consumption of the standard 60°C at partial load		0.64/0.64/0.64/0.73 kwh /cycle
Energy consumption of the standard 40° C at partial load		0.54/0.54/0.54/0.50kwh /cycle
Programme duration of standard 60° C at full load		179/179/179/228 min
Programme duration of standard 60°C at partial load		179/179/179/228min
Programme duration of standard 40°C at partial load		179/179/179/222 min
Water consumption of the standard 60° C at full load		48 L /cycle
Water consumption of standard 60°C at partial load		37L /cycle
Water consumption of the standard 40° C at partial load		37L /cycle
Remaining moisture content of the standard 60°C at full load		61/51/51/50%
Remaining moisture content of the standard 60°C at partial load		62/54/54/55%
Remaining moisture content of the standard 40°C at partial load		62/54/54/55%
Noise level of washing		59 dB
Noise level of spinning		76 dB (A)

# MAINTENANCES

---

## Note!

- Programme setting for testing in accordance with applicable standard EN60456.
- When using the test programmes, wash the specified load using the maximum spin speed.
- The actual parameters will depend on how the appliance is used, and maybe different with the parameters in above mentioned table.
- The household washing machine is equipped with power management system. The duration of the left-on mode time is less than 1 minute.
- The noise emissions during washing/spinning for the standard washing cycle at full load.

## Remarks:

- ① The energy efficiency class is from A (highest efficiency) to D (lowest efficiency)
- ② Energy consumption per year, based on 220 standard washing cycles for standard programme at 60°C and 40°C at full and partial load, and the consumption of the low-power modes. Actual energy consumption will depend on how the appliance is used.
- ③ Water consumption per year based on 220 standard washing cycles for standard programme at 60°C and 40°C at full and partial load. Actual water consumption will depend on how the appliance is used.
- ④ Spin-drying efficiency class from G (least efficient) to A (most efficient).
- ⑤ The standard 60°C programme and the standard 40°C programme are the standard washing programmes. These programmes are suitable to clean normally soiled cotton laundry and they are the most efficient programmes in terms of combined energy and water consumptions for washing that type of cotton laundry. The actual water temperature may differ from the declared cycle temperature.  
Please choose the suitable type of detergent for the various washing temperatures to get the best washing performance with less water and energy consumption.



# CATER-WASH

Please keep these instructions safe for future reference.

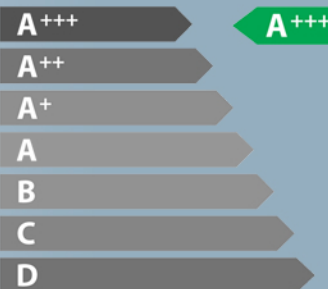

## Caterkwik Ltd

The Lakeland Catering Centre  
Newlands  
Ulverston  
Cumbria  
LA12 7QQ

01229 480001

[info@caterkwik.co.uk](mailto:info@caterkwik.co.uk)